

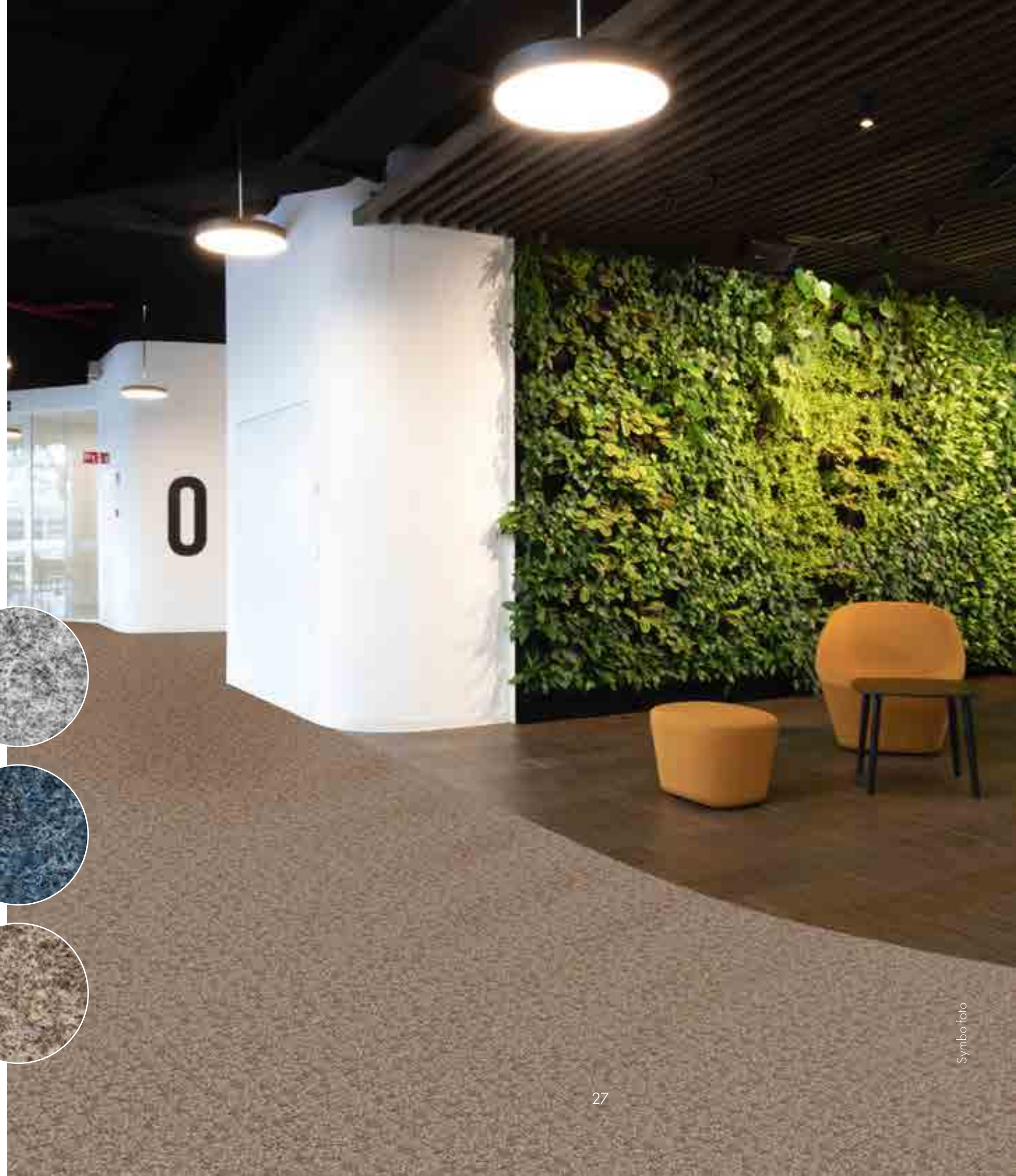

# NESTOR

## FLIESE

Herstellungsart	Nadelvlies
Definition	Grobfaser meliert
Polmaterial	100 % PP
Polgewicht	ca. 700 g/m <sup>2</sup>
Gesamtgewicht	ca. 3.800 g/m <sup>2</sup>
Gesamtdicke	7,0 mm
Polhöhe	3,0 mm
Rückenausstattung	Polyflex
Format	50 x 50 cm
Special	Akustikrücken auf Anfrage

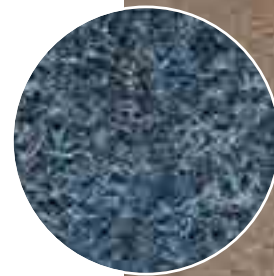
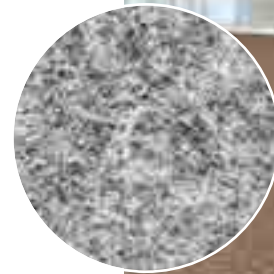



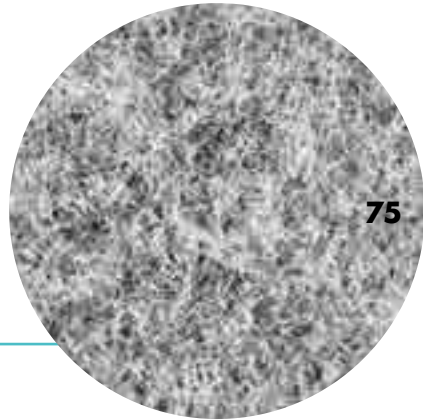

75

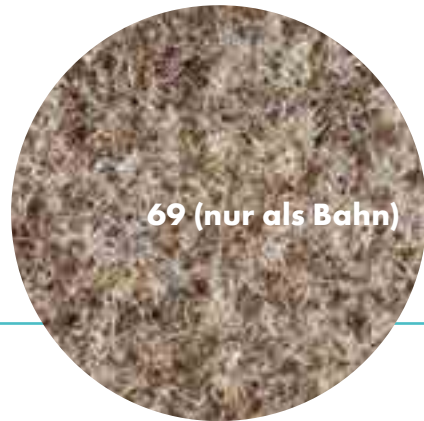

69 (nur als Bahn)

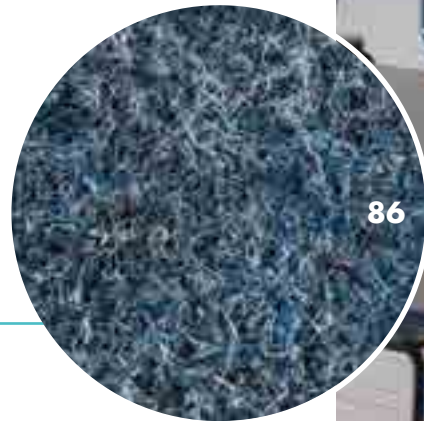

86

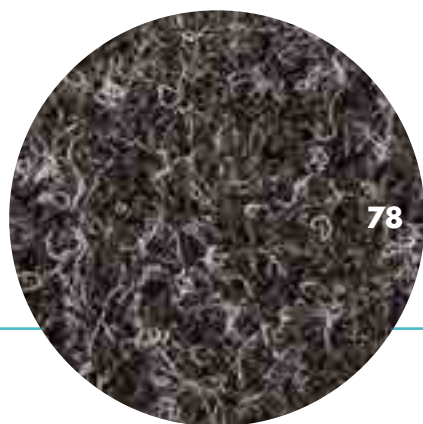

78



77

